

Welcome to the Urbandale Public Art Gallery



9-11 Memorial Steel Fire Station #42 3927 121st Street

The 9-11 Memorial Steel was given to the Urbandale, Clive and Windsor Heights Fire Departments by the New York Port Authority to serve as a memorial to the 343 Firefighters who gave their lives on 09/11/2011.

Artist:

New York Port Authority & Iowa Outdoor Products

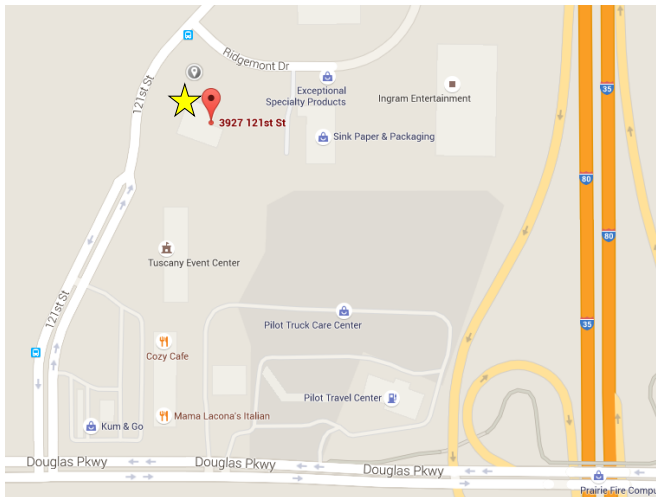

Across Currents

Walker Johnston Park Trail between the bridge and the Library

A metaphor for people of different backgrounds face to face at a poignant first meeting; a sea fish and a river fish. In between the two fish is a set of laser cut haiku poems that narrate the meeting to unveil the auspiciousness of the meeting of the two worlds.

Dimensions:

15' W x 11' H x 4' D

Artist: Bouunak Thammavong

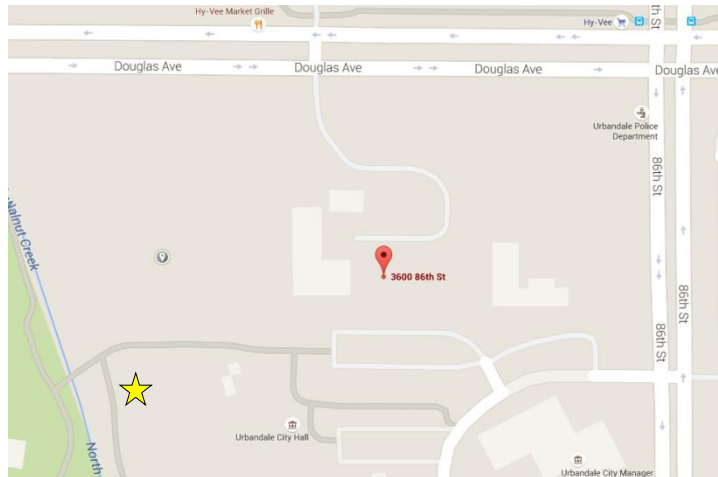

Afternoon Stroll
(Duck & Ducklings)

Jackaline Baldwin
Dunlap Park

Patricia Dr. & Dewey Gibbs Rd.

This is an original sculpture by Leo DiMarmo of a mother duck and her four ducklings taking an afternoon stroll.

Dimensions:
14" W x 65" D

Artist: The Large Art Company

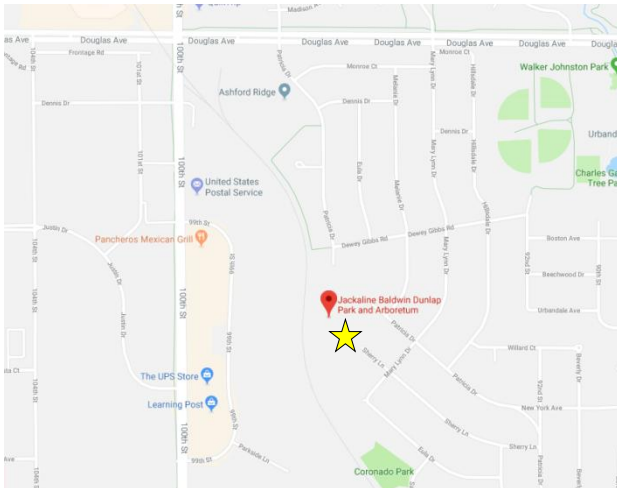

Animato

Kollmorgen Park

(formerly known as Walnut Creek Hills Park)

16211 Tanglewood Dr.

The artwork is a collection of strokes or marks that one might see while reading hand written sheet music. The strokes and shapes have been extruded into three-dimensional forms then composed to emulate specific musical terms. “Animato” is a musical term, which means to play in a lively and animated way.

Dimensions:

14' H x 4' D x 6' W

Artist: Duke Oursler

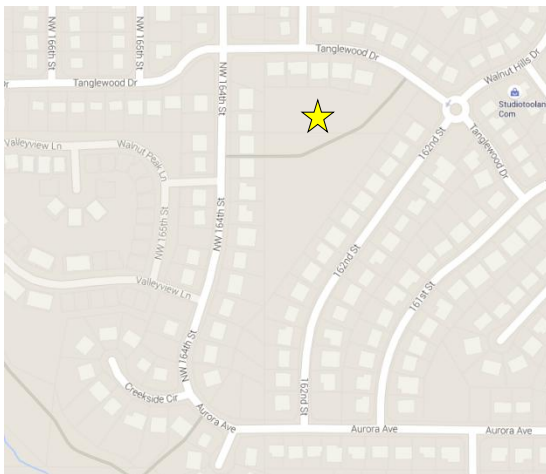

Arching Tulip
Sharon Heights Park
4624 78th Street

The artwork is a piece about resilience,
a plant that got knocked down but
grew and flowered.

Dimensions:
10' H x 2.5' D x 6' W
Artist: Mike Sneller

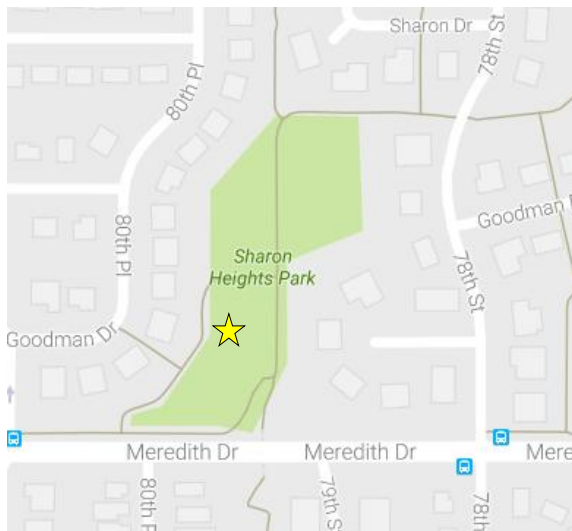

ATLAS
**Urbandale Senior
Recreation Center**
7305 Aurora Avenue

The artist was thinking that Atlas is an abstract figure that's holding the World on its shoulder.

Dimensions:

7' H x 38" D x 37" W

Artist: James Bearden



At the Waters Edge

L.A. Ward Park

3900 Block NW Urbandale Dr.

The artist was thinking about both land and water. As the artist started to think about the animals that live in both of these areas, the most recognizable creatures were a bird and a fish. Once the viewer explores the piece, they will find details that relate to these animals.

Dimensions:

9' H x 7' D x 5' W

Artist: Zach Bowman

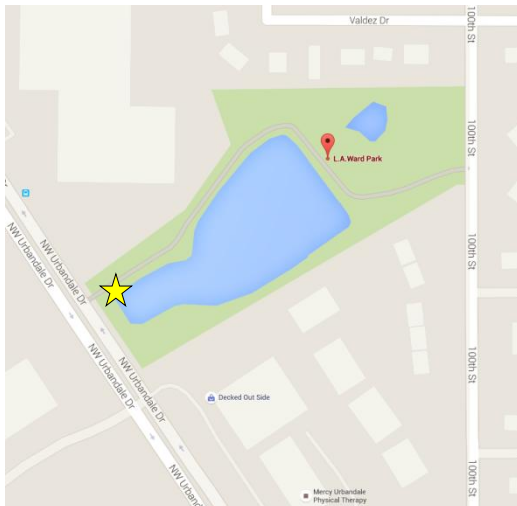

Barrett Boesen Sculpture

Barrett Boesen Park & Natural Playscape

5301 156th Street

Dedicated to remembering Barrett's enormous love for children and his unique ability to keep joy at the center of everything he did. Inspired by a photo of Barrett Boesen with his nieces Annabelle, Olivia, Grace, Harper and nephew Max walking hand in hand.

Dimensions:
7' H x 15' W

Artist: V. Skip Willits

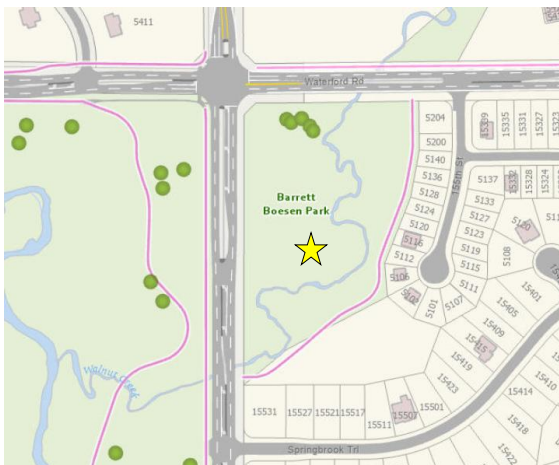

Baseball Slugger & I Can Do It

Miracle League Field

Northview Park

4871 78th Street

The Miracle League Field is a field with a special rubberized playing surface for children and adults with special needs.

Artist: Randolph Rose Collection

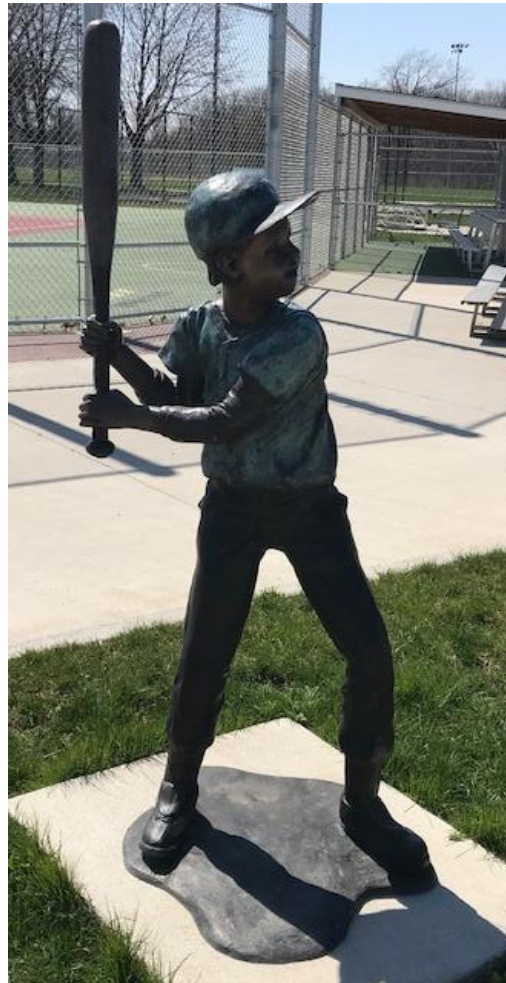

Beacon of Hope

Meredith Park

On Meredith Drive between
82nd & 83rd Street

This piece is in memory of Tom
Carder, Entrepreneur,
Philanthropist and Art Enthusiast.
8/26/1953 – 1/10/2015

Dimensions:

20' H

Artist: Quality Manufacturing



The Butterfly Dress

Lions Park

72nd Street & Aurora Avenue

This piece is about beauty, loss and transformation. The artist made this piece as a way to remember all the fun times with his little girl and how she's growing and transforming into a more beautiful and interesting person.

The imagery of the piece is his daughter's school uniform slowly transforming into butterflies.

Dimensions:

4' H x 14" D x 4' W

Artist: Kyle Fokken

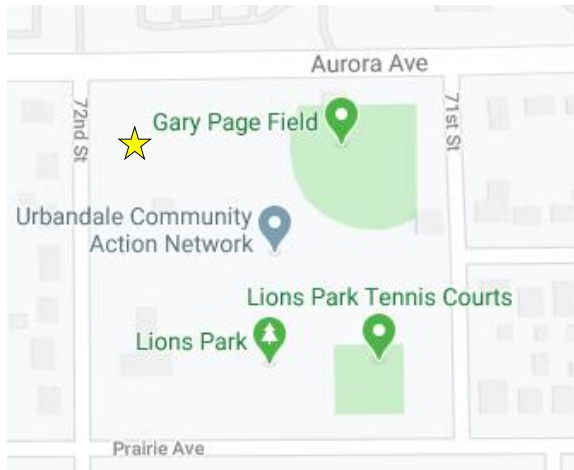

Cherishing our Freedom American Legion Post #663 6805 Douglas Avenue

Our mural, born from a community competition, serves as a tribute to the courageous men and women who have protected our freedom. We are grateful for their selfless service. Urbandale's annual July 4th fireworks celebration inspired the incorporation of rockets red glare bursting in air, which emerge from the stars on the American flag. This sculpture was made possible by the City of Urbandale, Urbandale American Legion Post 663, Urbandale VFW and generous grants from BRAVO of Greater Des Moines and the Polk County Board of Supervisors.

Dimensions:
12' H x 75' W

Artists: Jan Hutchison and Sarah Del Campo

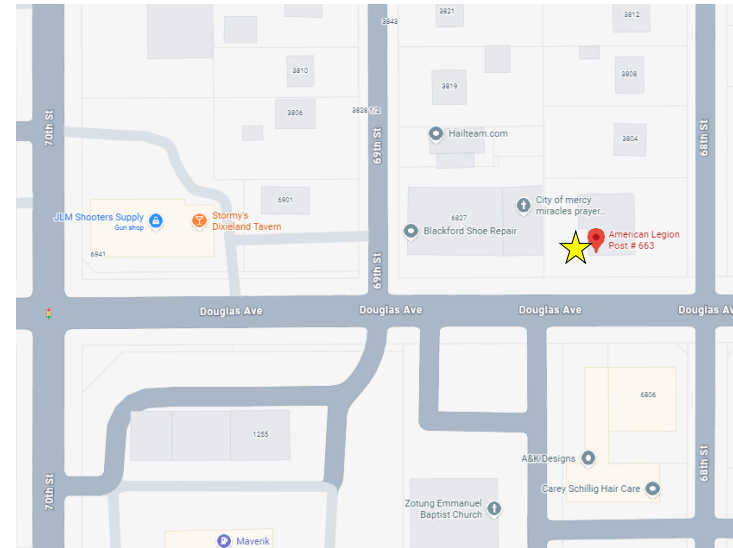

Circle of Fun
Charles Gabus Memorial Tree
Park and Gardens
3600 86th Street

Circle of Fun is of three children
balancing on a circle.

Dimensions:
60" H x 72" W

Artist: Randolph Rose Collection

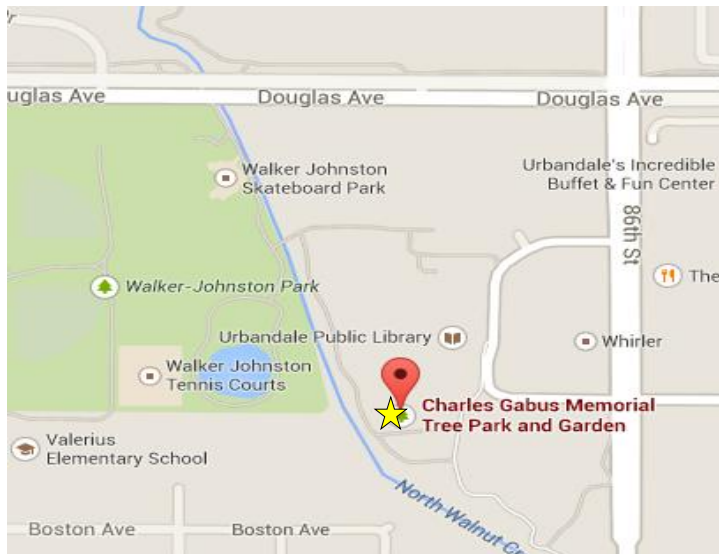

Firefighter Fire Station #42 3927 121st Street

The statue is a memorial to Mike Mercurio, an Urbandale firefighter who died in the line of duty in 2005. The statue sits in the Monte Burr Memorial Garden, which was dedicated in October, 2011.

Dimensions:
6.5' H x 27" W

Artist: Created in Johnston

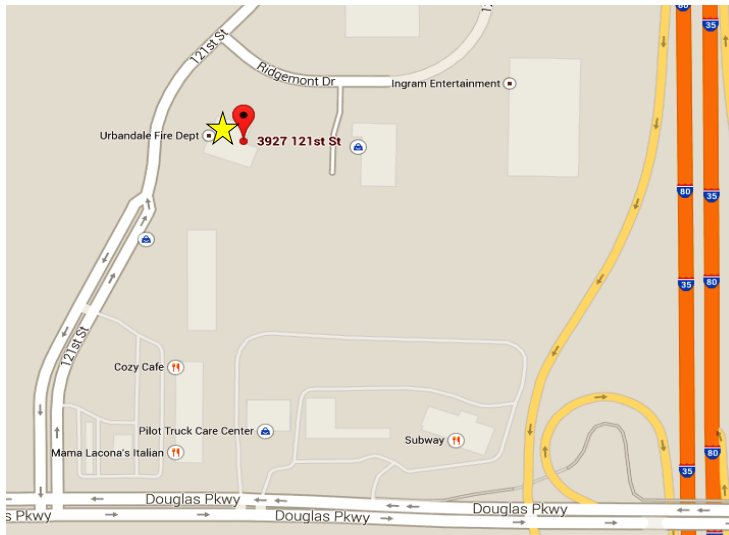

FLIGHT

SW Corner of 86th Street & Douglas Ave.

Flight explores the chaotic fervor with which a violinist plays their instrument and attempts to capture this turbulent beauty.

Dimensions:

15.5' H x 24" D x 36" W

Artist: Matt Miller

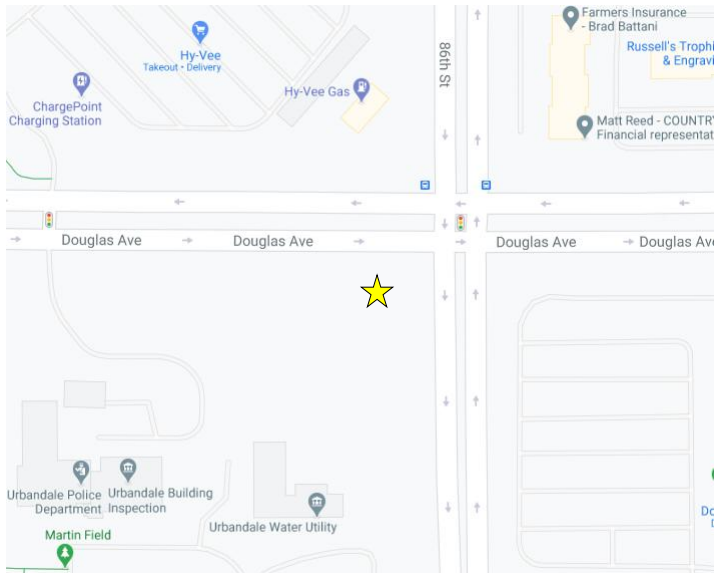

Forever Broken

Bestland Park

91st Street & Meredith Dr.

A stainless steel sculpture based on the concept of infinity, or rather, the lack of such a possibility. The piece looks as though it was once continuous and has been broken, speaking to the idea of eternity and its impossibility.

Dimensions:

7.6' H x 6.6' D x 8' W

Artist: Kevin Casey

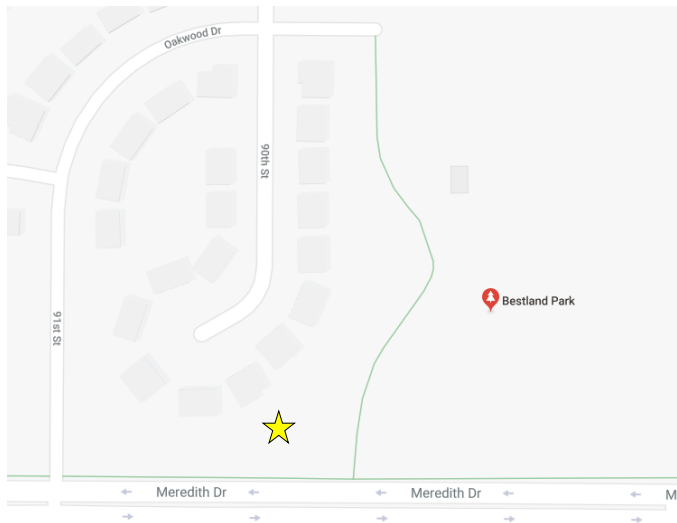

Good Times

Walnut Creek Regional Park
4100 Walnut Creek Park Rd.

Dimensions:

7.8' H x 4.5' D x 4' W

Artist: The Bronzeman Company

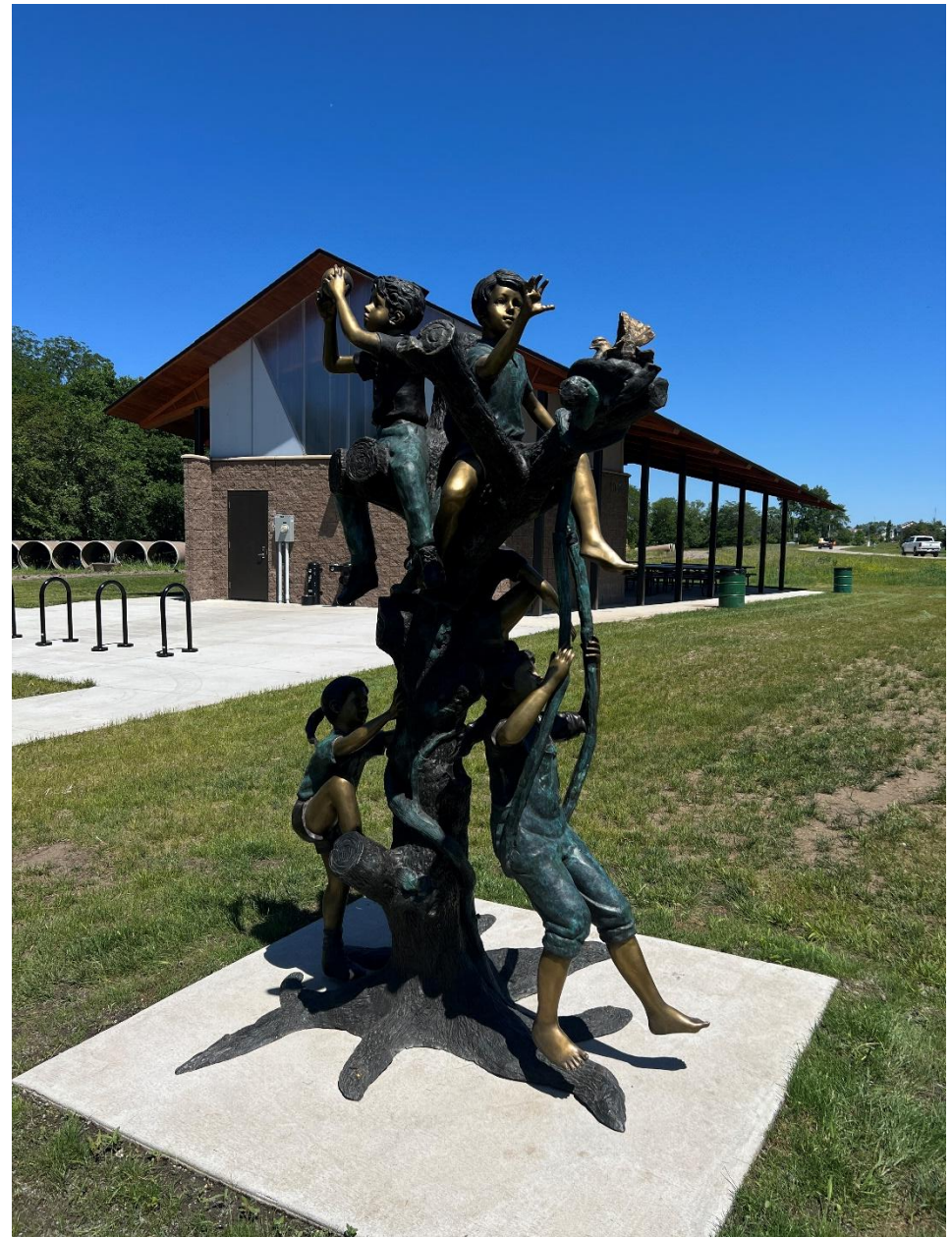
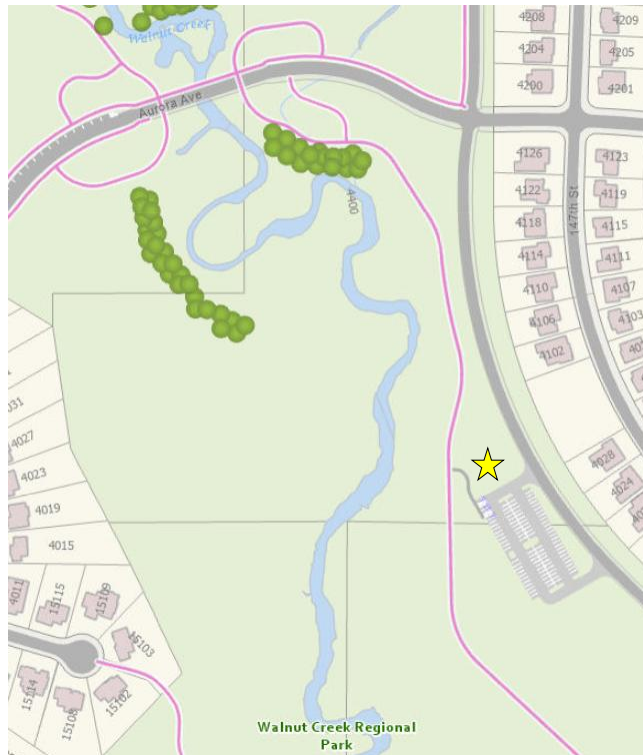

GROW

Waterford Park 156th Street & Northview Dr.

“**GROW**” is a weathered steel, painted steel and plexiglass sculpture. The artist wanted to show Fall colors out of season so they can be appreciated year-round.

Dimensions:

9.8' H x 5' D x 5' W

Artist: Tim Adams

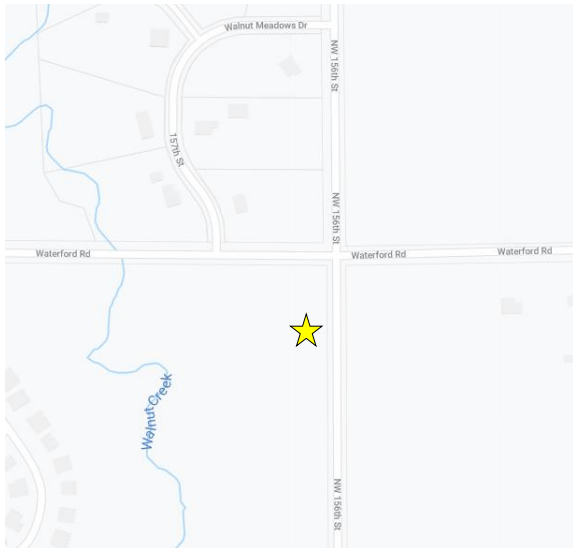

Hooked

Deer Ridge West Park 147th Street & Briarwood

For this piece, the artist was thinking about both land and water. The artist extracted different shapes from a bird and a fish to come up with an abstract, representational sculpture.

Dimensions:

12' H x 4.5' D x 10' W

Artist: Zach Bowman



Interlace

Horizon's Ridge Park

(Walnut Creek Regional Park)

Next to Playground and Trail

Reminiscent of the natural structure of plants from microscopic to large trees.

This piece hopes to show the connection between all the things in our environment. With an opening to allow visitors to enter, people are able to experience the engagement of the world around them that often goes unnoticed.

Dimensions:

3' W x 6' H x 3' D

Artist: Sarah Deppe

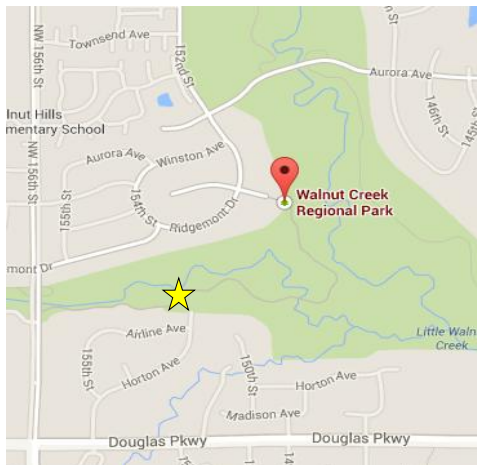

Jardin de la Paz

Colby Woods

Behind The Reserve on Trail

A couple is suggested by only two heads and single torso. Each head is formed only from a bent piece of metal. The figures have no face, but can appear to look and enjoy. The figure has no ethnicity, but represents anyone/any viewer.

Dimensions:

8ft high, 26 inches wide

Artist: Gail Chavenelle

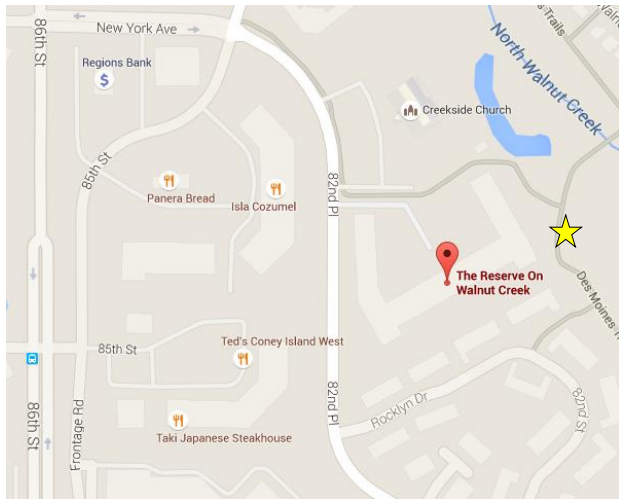

Lawson Trolley Park 70th Street & Roseland Drive

The history of ridership on the streetcar is preserved at the Trolley Park. This historical plaque is a memorial to the importance of the trolley in Urbandale.

Dimensions:

21' L x 11' H x 8' W

Artist: Craig Pippet

Artwork concept by the
Downtown Urbandale
Neighborhood Association
(DUNA)

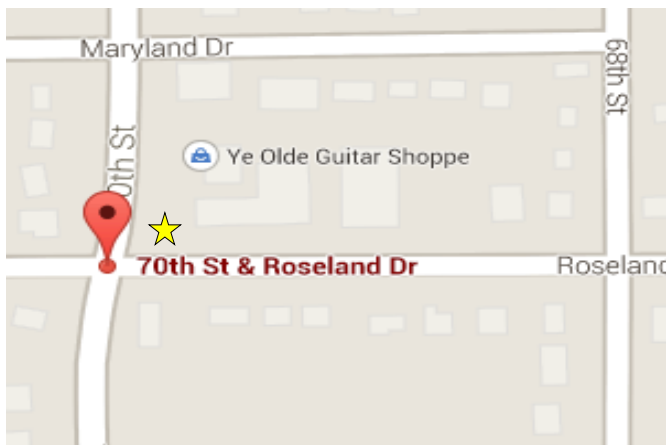
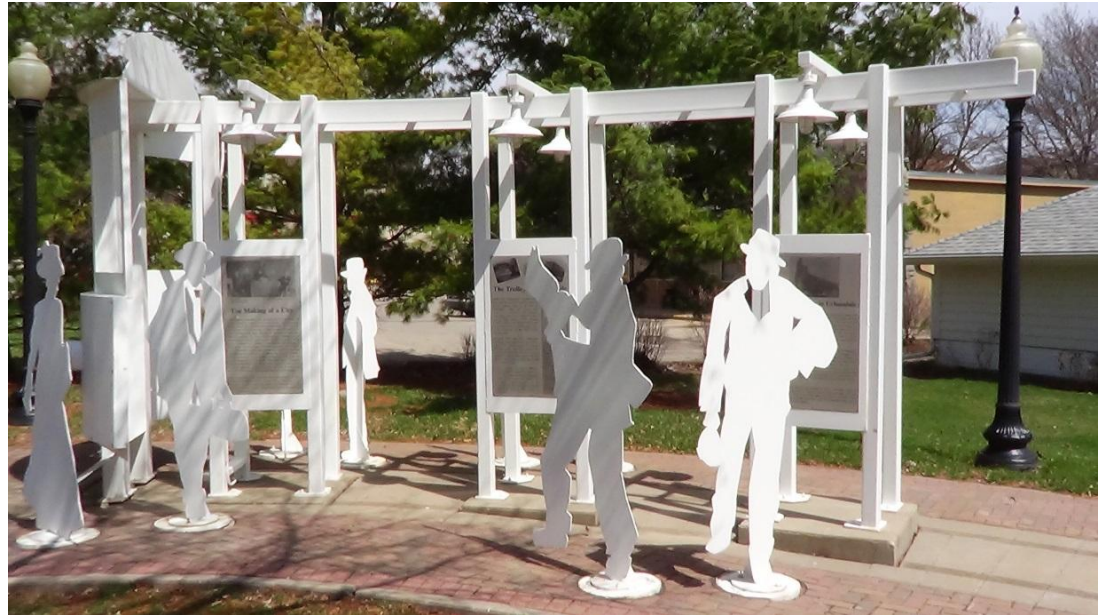

Leapfrog

Lions Park

72nd Street & Prairie Avenue

Girl jumping over back of boy playing leapfrog. It is located on the east side of the Ralph Whitten Shelter at Lions Park.

Dimensions:

61" H x 51" W x 21" D

Artist: Randolph Rose Collection



Letting Go
Acadia Park
4655 Centennial Blvd.

The artist states that the young woman represents your mind and thoughts. The bird represents our negative thoughts and feelings. Worries and negative thoughts are being released which will make way for a fresh positive mindset.

Dimensions:
7' H x 24" W x 32" D
Artist: Judd Nelson

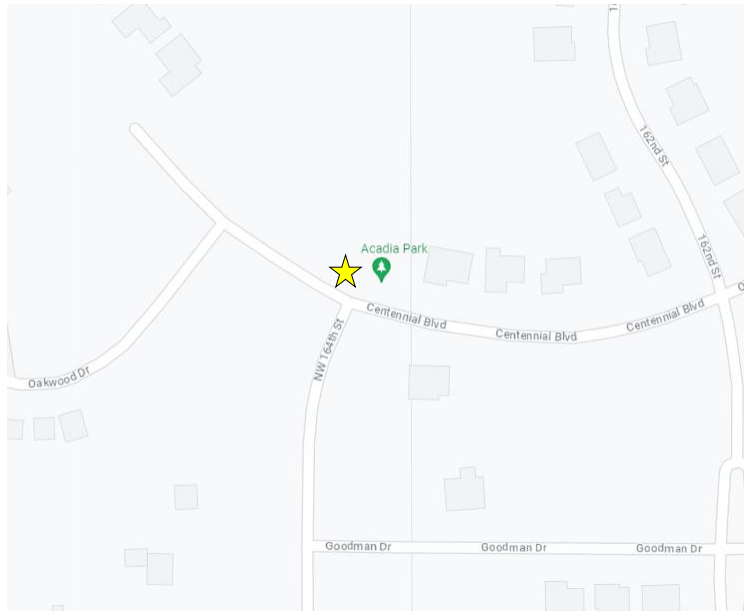

Murmur

Walnut Creek Regional Park 152nd Street & Meredith Dr.

This is a welcoming gateway to Walnut Creek Regional Park. Symbolically, the soaring array of birds encourage us to take flight, celebrate the environment, and work together as a community.

Artist: Seth Emerson Palmiter

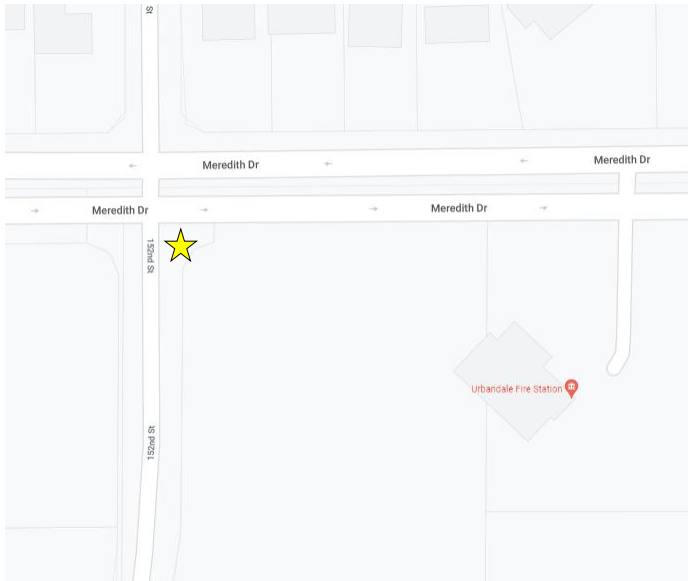

Pillars

**Walker Johnston Park
8900 Douglas Avenue**

The six pillars outside the
Giovannetti Community Shelter
are topped with metal hand
ornaments to represent the

6 pillars of Character:
***Trustworthiness, Respect
Responsibility, Fairness
Caring, Citizenship***

Artist: Sticks

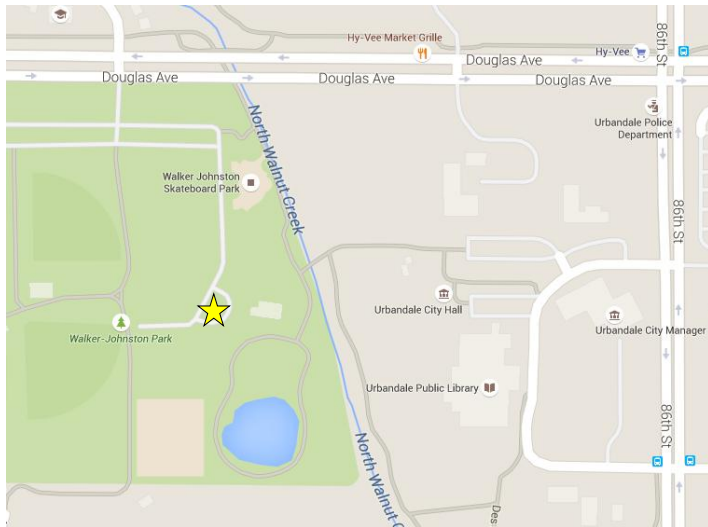

Portal

North Karen Acres Park
77th Street and Douglas Avenue

The piece was intended to both create a focus with which to visually integrate the work into its surroundings and simultaneously distort and shift that perception

Dimensions:

10' H x 3' D x 5' W

Artist: Victoria (Reed) Nieman

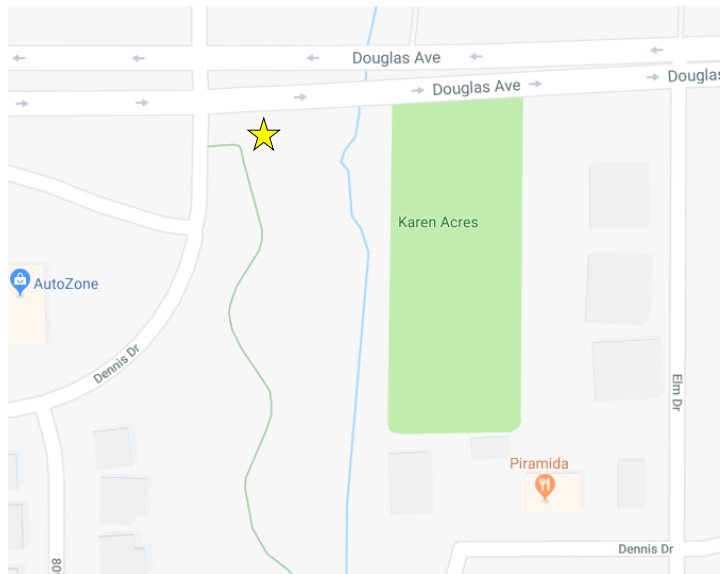



Love you to the Moon
Raise You the the Stars
Douglas Avenue Interchange

These pieces were created to beautify and enhance the Douglas Avenue Interchange in Urbandale.

Artist: Clint Hansen

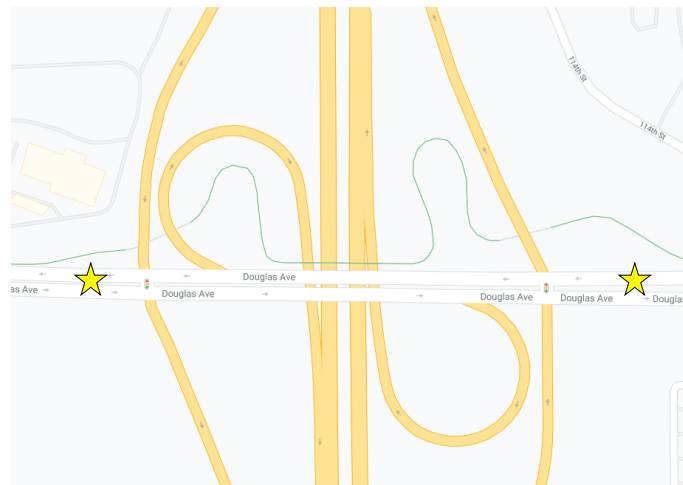

Ray

Deer Ridge Park
Near the Playground
13900 Buena Vista Drive

Ray is a radiating burst of vibrant
warmth and energy!

Dimensions:

2' D x 8' H x 8' W

Artist: Tim Adams



Skateboarder

Walker Johnston Park- Skate Park
9200 Douglas Avenue

The Skater statue was
commissioned to celebrate the
City's skate park.

Dimensions:

12' H x 18" Diameter

Artist: Sticks

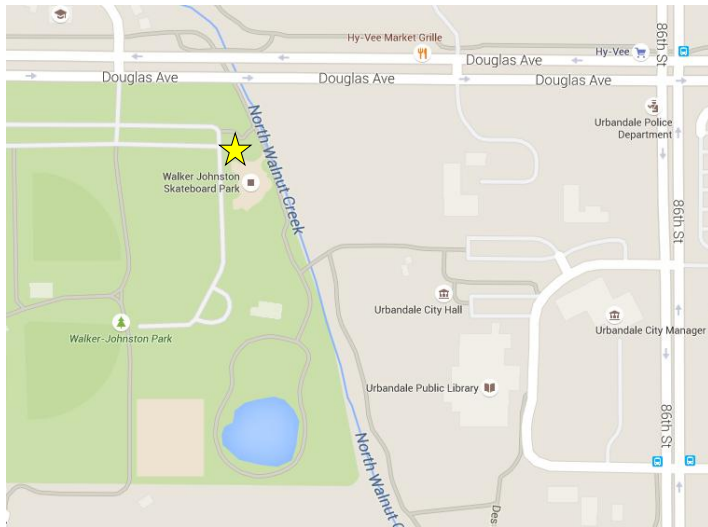

The Sound of Color

Murphy Park

67th St. & Urbandale Ave.

Wind and Sun are two of nature's forces the artist chose to work with for this piece. The chimes give notice when a slight breeze moves through the air. The color draws the eye to the sound. It's the same concept when you hear a bird sing and look around to see where the chirp is coming from.

Dimensions:
8' H x 4' D x 5' W

Artist: Tim Adams

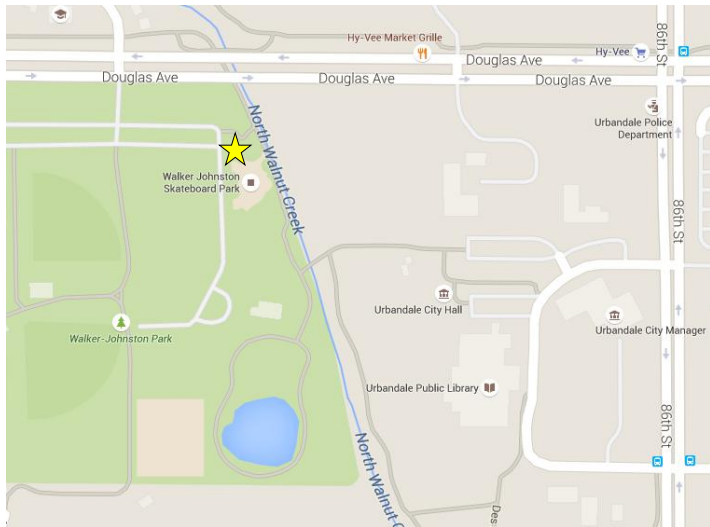

Split Seam

Hallbrook Park

144th St. and Douglas Pkwy.

"Split Seam" was created to capture the moment a seed pot erupts sending forth potential replications of itself. As these future plants grow upward it perpetuates the life cycle of the plant.

Dimensions:

3.5' D x 10.5' H x 3.5' W

Artist: Timothy Jorgensen

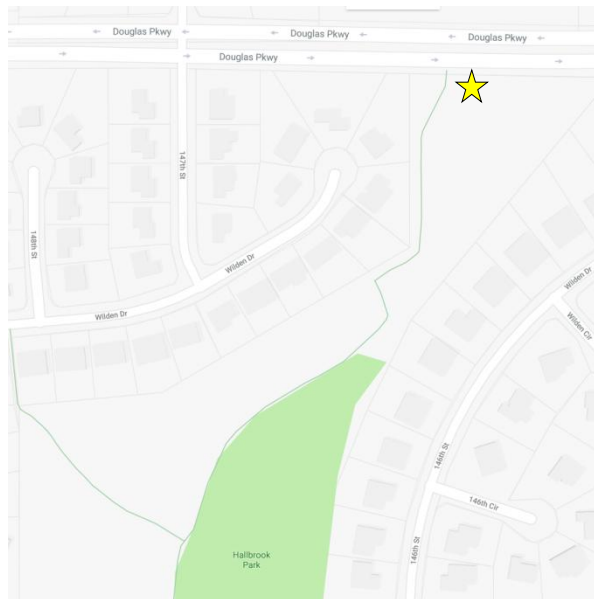

Strata

3600 86th Street

Strata refers to layers of history that serve as the foundation for cultivating our future. Elements of the sculpture reference Urbandale's architecture as well as mechanical components of train engines such as gears and wheels, which is a nod to Urbandale's past as a railroad town. Strata signifies the growth of Urbandale by honoring the past, energizing the present, while hinting at the future. **This piece was commissioned in October, 2016, for the 2017 Urbandale Centennial.**

Dimensions: 22 ½' H x 12 ½' W

Artist: Dan Perry

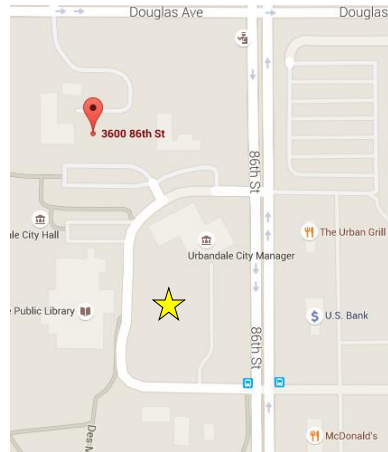

Summer Fun

Lakeview Park

80th Street & Aurora Avenue

Two children holding a turtle while seated on a log. Near Lakeview Pond at Lakeview Park.

Dimensions:

85" L x 31" D x 54" H

Artist:

Randolph Rose Collection

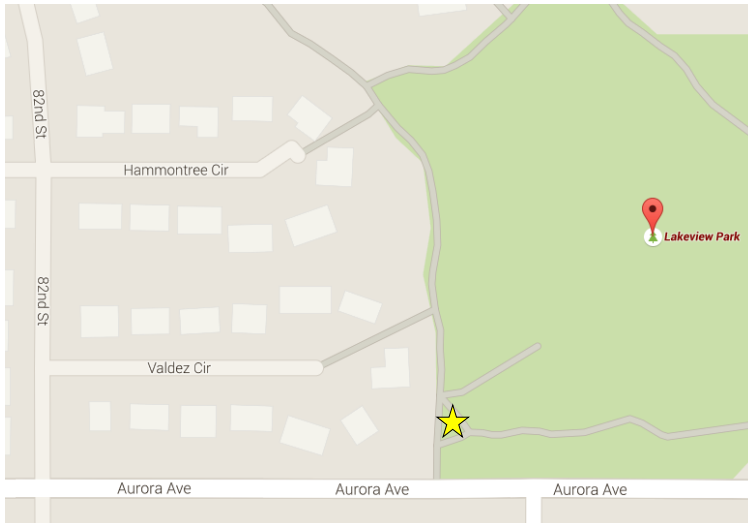

Sunrise

Lakeview Park

80th Street & Aurora Avenue

The sun comes shining up over the River where I live every morning. This is my rendition of the feeling I get from it.

Dimensions:

30" W x 25" D x 8' H

Artist:

V. Skip Willits

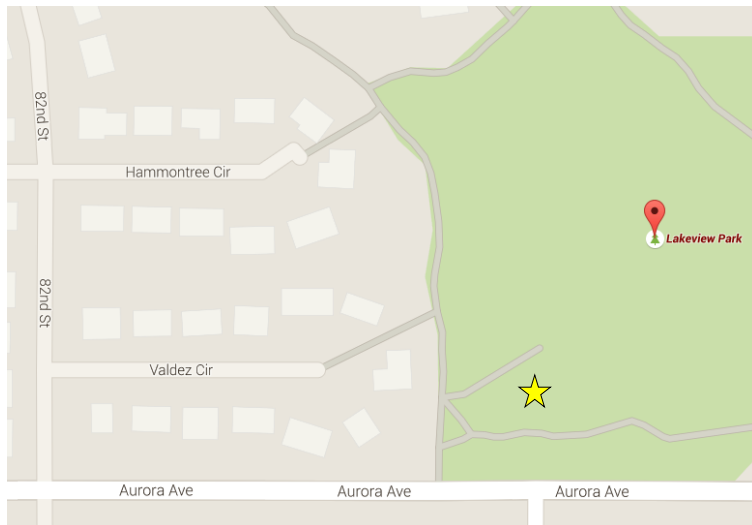

Sweet Pops of Brilliance

Ashleaf Park

3934 Mary Lynn Drive

It reminds me of my childhood
when being good meant getting a
sweet lollipop.

Dimensions:

4' W x 4' D x 10' H

Artist:

Craig Snyder

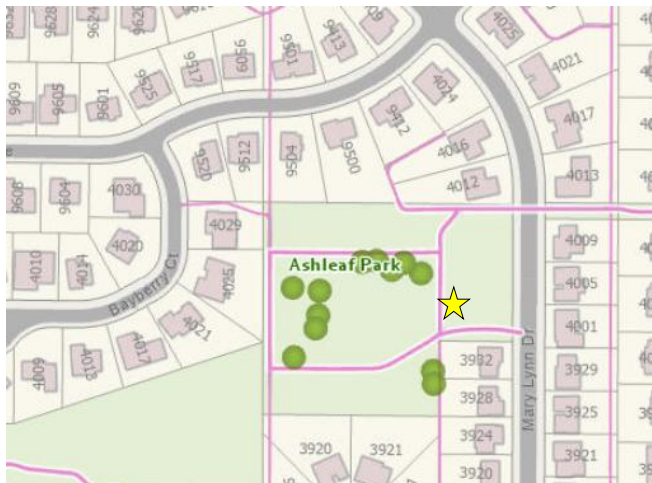

Talking Times

**Charles Gabus Memorial
Tree Park and Gardens
3600 86th Street**

Talking Times is of a grandfather sitting on a bench with his granddaughter reading a book.

Dimensions:

70" L x 20" D x 50" H

Artist: Randolph Rose Collection

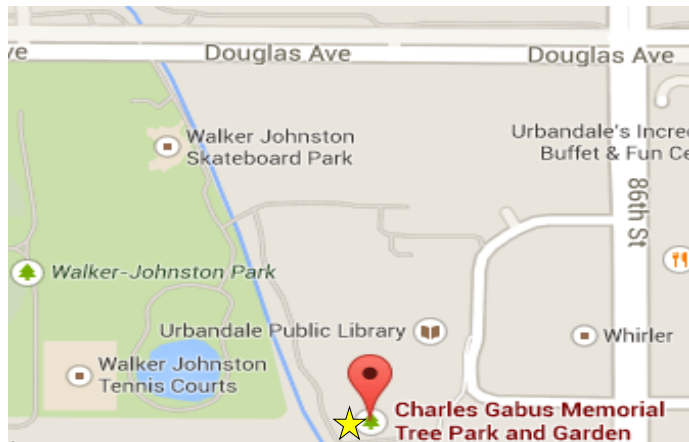

Telescope
Urbandale Library
3520 86th Street

An interactive teleidoscope (a kind of kaleidoscope) sculpture.

The garden sculpture is an atomic design, which includes a stationary base and a rotating bowl. The artist also crafts each of the two suspended brass teleidoscope that are part of the sculpture and can be used to view kaleidoscope patterns of blooming plants in the rotating bowl.

Dimensions: 55" H x 48" W

Artist: Bob Anderson

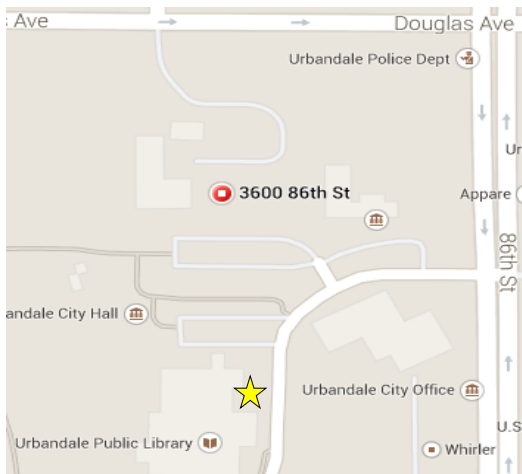

Whirler
Soccer/Softball Complex
104th Street and Meredith Drive

This piece is an abstract representation of a maple tree pod. The artist simply enjoyed watching the form as it twirled its way toward the ground in fall.

Dimensions:
2' D x 8' H x 3' W

Artist: Bounnak Thammavong

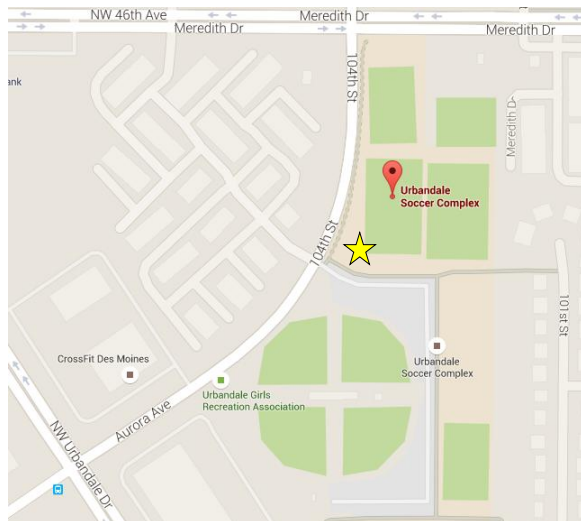

Wolf Family

Jackaline Baldwin

Dunlap Park

Patricia Dr. & Dewey Gibbs Rd.

Dimensions:

Standing Wolf: 27" H x 50" W x 14" D

Howling Wolf: 37" H x 22" W x 15" D

Artist: The Bronzeman Company

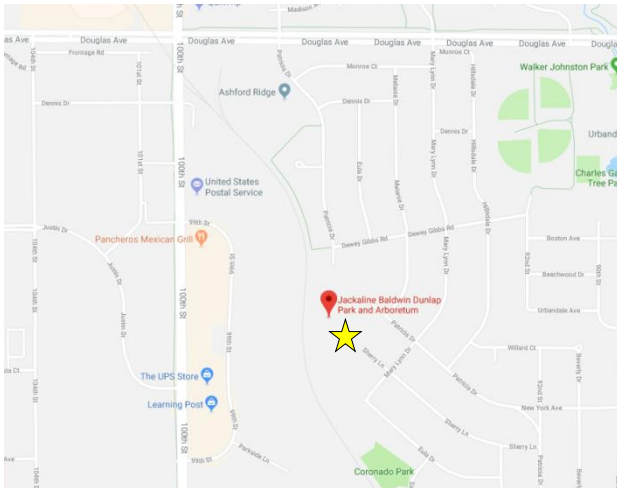

You are the Sun,
the Moon and the Stars

Days Run Park

Near the Playground at 124th
Street & Tanglewood Drive

This piece is a depiction of
the heavenly bodies.

Dimensions:

27" D x 68" H x 57" W

Artist: John Brommel



Urbandale Art Park **3600 86th Street**
4 temporary sculptures installed annually at City campus complex

For current Art Park Sculptures, [visit our website.](#)

